



# Installation Instructions JFX100 Bracket Kit

## 1. Inventory

Before beginning installation, inventory your JFX100 bracket kit to items listed.

Item	Qty	Description
A	1	Bracket/Wallmount
B	1	Plate/Top Hat Span
C	2	Screw, 3/8-16 x 1-1/2 inch Lg
D	2	Rubber Washer
E	2	Lock Washer
F	2	Flat Washer

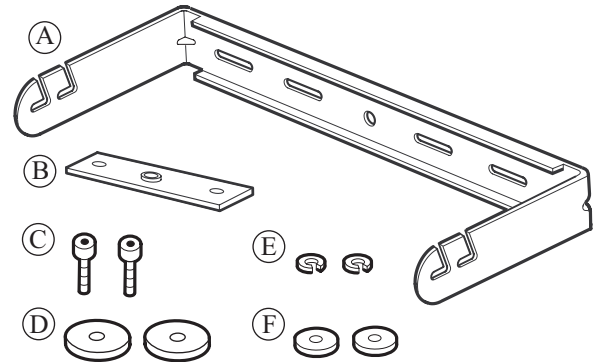

**Warning:** Installation should only be done by an experienced technician. Improper installation may cause damage, serious injury, or death.

## 2. Mounting the Bracket

Due to various construction methods and materials, the hardware for securing the bracket to the mounting surface is not supplied.

It is recommended that you consult a building professional for the proper mounting hardware before mounting the bracket (A). When horizontally mounting an enclosure make sure the four openings in the bracket arms face upward.

## 3. Installing the Plate/Top Hat Span

Remove the 2 screws (G) on each side of the top hat. Fit the span plate (B) into the recess and secure it to the cabinet with the same 2 screws (G) just removed.

## 4. Removing the Threaded Plug

In the center of the top fly mount is a 3/8-16 plug (H). Remove it using a Phillips head screwdriver.

## 5. Choosing which Slot to Use

There are two slots in the bracket arm. The forward slot is used in these instructions. The forward slot is intended for use with weather protected cabinets. The back slot is intended for indoor installations where cable connections are made to the terminal strip.

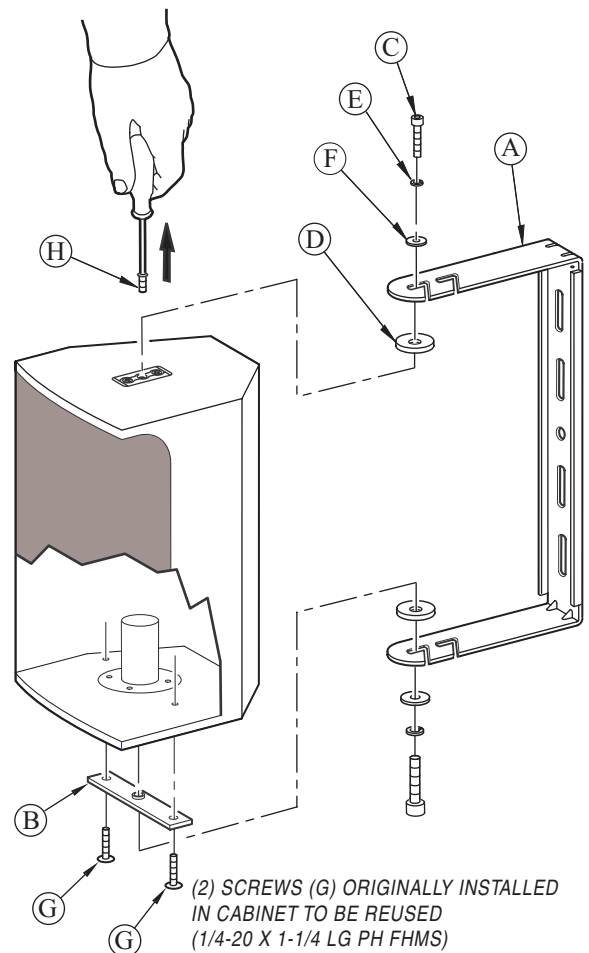

## 6. Hanging the Cabinet

- a. Place a rubber washer (D) on the bracket's (A) lower arm. Center it on the appropriate slot.
- b. Position the cabinet between the bracket arms.
- c. Hold the cabinet in position and insert the screw (C) with its lock washer (E) and flat washer (F) through the bracket's bottom slot and into the threaded hole in the top hat spanning plate (B) and hand tighten.
- c. Align the appropriate slot in the bracket's top arm to the cabinet's 3/8-16 threaded hole.
- d. Position a rubber washer (D) between the slot in the bracket's (A) top arm and the cabinet's top 3/8-16 threaded hole.
- e. Hold the cabinet in position and insert the screw (C) with its lock washer (E) and flat washer (F) through the bracket's slot and into the cabinet's top threaded hole and hand tighten.
- f. Position cabinet and tighten both screws (C) with a 5/16 Allen wrench.

## 7. Pipe Clamp Installation

A user-supplied, heavy duty pipe clamp with 1/2 inch instrument yoke attachment bolt may be affixed (Altman 510-HD or similar). Assemble the pipe clamp to the bracket (A) as shown.

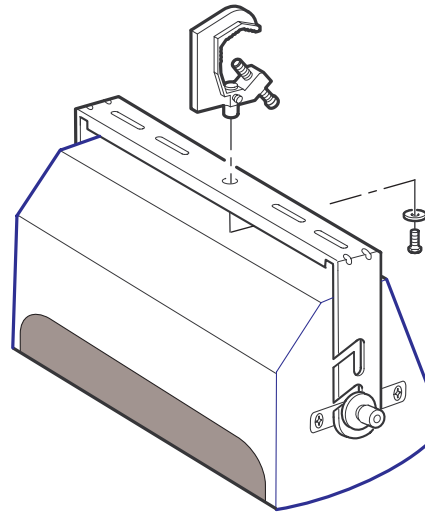

If you have questions about the JFX100 bracket installation please contact the EAW Application Support Group:

Tel 800-992-5013 (USA only)  
Tel 508-234-6158  
Fax 508-234-8251  
E-mail [asg@eaw.com](mailto:asg@eaw.com)

**Thank you for purchasing  
EAW products**

The Laws of Physics | *The Art of Listening*

