

5. Screw a Threaded Standoff onto each lower Stud of the Connecting Straps.

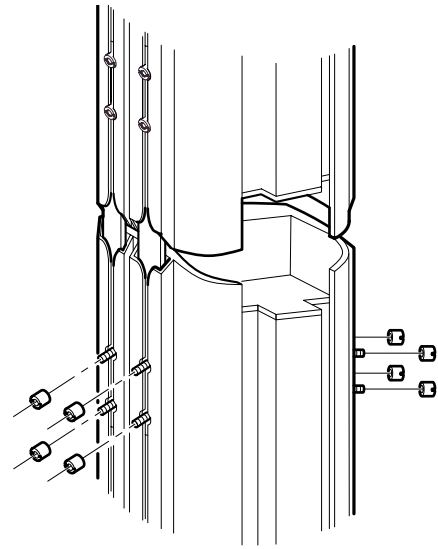

6. Ensure all Threaded Standoffs are fully inserted into the Enclosure Channel Cutouts and are seated against the Support Straps.

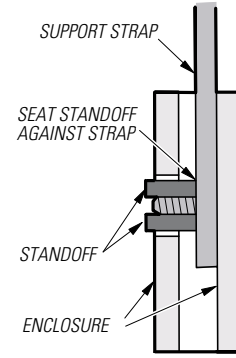

7. Using a 1/2" wide, flat-tip Screwdriver, firmly tighten all Standoffs.

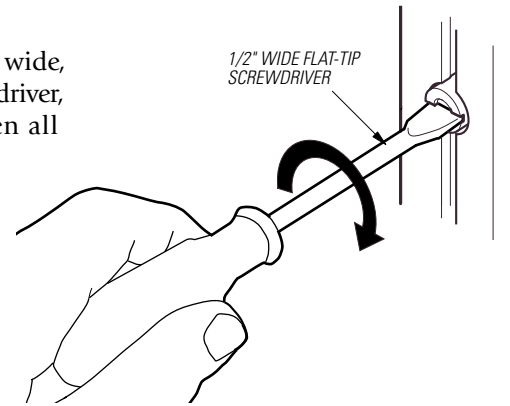

8. Repeat Steps 1 to 7 for a third Enclosure.

9. Apply one drop of Loctite 242 to each tightened Standoff as shown in the drawing. Once applied, allow the Loctite to cure undisturbed for a minimum of 6 hours or according to its directions.

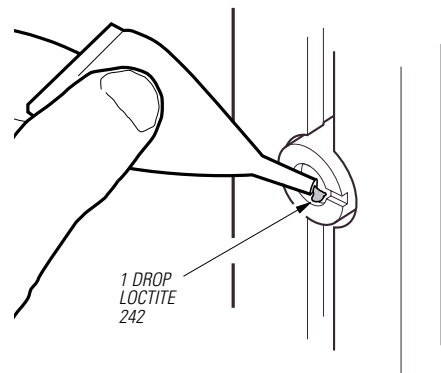

If you have any questions about installing or using the DSA Suspension Kit, please contact the EAW Application Support Group for assistance:

EAW ASG  
One Main Street  
Whitinsville, MA 01588 USA

Tel 800-992-5013 (USA only)  
Tel 508-234-6158  
Fax 508-234-3776  
E-mail [asg@eaw.com](mailto:asg@eaw.com)

Thank you for purchasing  
EAW products

The Laws of Physics | The Art of Listening



P/N RD0090 (B) 3NOV03 EAW is the worldwide technological and market leader in the design and manufacture of high-performance, professional loudspeaker systems.

# EAW Instructions/DSA Series Fly-Bar Kit and Enclosure Connecting Kit

## DESCRIPTION:

The DSA Fly-Bar Kit and Enclosure Connecting Kit are used for suspending DSA Loudspeakers.

**WARNING:** Suspending anything, especially overhead of people, should be done with extreme caution. Always engage the services of a certified professional who is qualified to determine the requirements for, and to implement overhead rigging. Only persons with the knowledge of proper hardware and safe rigging techniques should attempt to suspend DSA Loudspeaker Systems overhead. Failure to follow these precautions may result in equipment damage, injury, or death.

**WARNING:** When suspending DSA Enclosures, the Threaded Standoffs, Support Strap Studs, and Connecting Strap Studs carry the weight of the Loudspeaker as a shear load, transferring it to the Straps themselves. For proper transfer of the load, all Standoffs MUST slide into the Half-Moon Cutouts and seat against the Support Straps. Do not, under any circumstances, suspend a Loudspeaker if any Standoff is not fully seated against its Support Strap surface. Failure to follow this warning may result in equipment damage, injury, or death.

**CAUTION:** For each of these procedures, make sure the correct end of the Loudspeaker, Signal End or Power End, is "up" for the intended application.

## WLL (Working Load Limit)

The Fly-Bar Kit will support the weight of any DSA Cluster permitted in the DSAPilot control software. The Enclosure Connecting Kit is required for and will support the weight of additional Enclosures in over-under Clusters permitted in the DSAPilot software. Permitted Clusters with side-by-side Enclosures require two Fly-Bar Kits, one for each Enclosure.

## DSA Fly-Bar Kit Parts List, EAW P/N 0007445:

Item	EAW P/N	Qty	Description
A	0007197	1	Fly-Bar
B	0007526	2	3/8" Shackle
C	0007449	4	Support Strap
D	0006036	4	1/4-20 x 1" Bolt
E	0006035	8	1/4 in Flat Washer
F	103012	4	1/4-20 Lock Nut
G	RD0090	1	Instructions/DSA Series Fly-Bar Kit and Enclosure Connecting Kit (not shown)
H	0007221	8	1/4-20 Threaded Standoff
I	0007522	1	Loctite Threadlocker 242

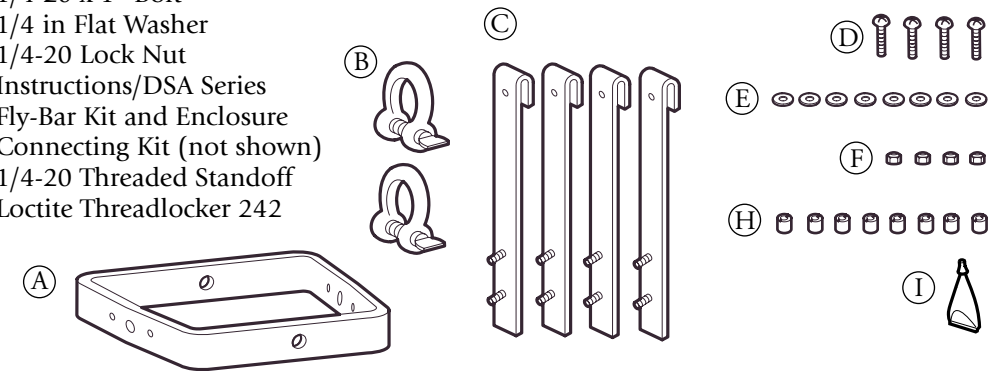

## DSA Enclosure Connecting Kit Parts List, EAW P/N 0007446:

Item	EAW P/N	Qty	Description
G	RD0090	1	Instructions/DSA Series Fly-Bar Kit and Enclosure Connecting Kit (not shown)
H	0007221	16	1/4-20 Threaded Standoff
I	0007522	1	Loctite Threadlocker 242
J	0007198	4	Connecting Strap

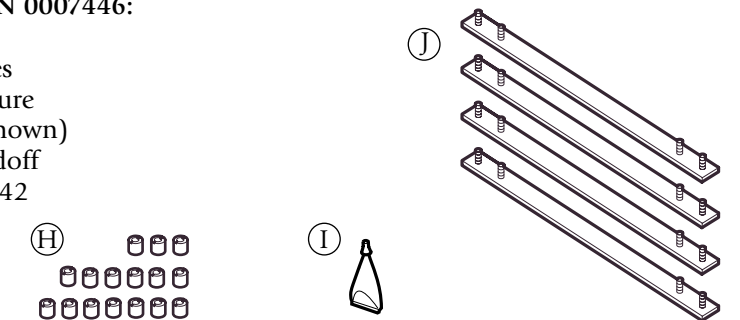

## USAGE

Install a DSA Fly-Bar on the Loudspeaker Enclosure to attach user-supplied rigging hardware for suspending a DSA Loudspeaker. Install a DSA Enclosure Connecting Kit to attach each additional DSA Loudspeaker underneath a suspended DSA Loudspeaker.

## SUSPENSION (Requires one Fly-Bar Kit)

1. Loosely attach the four Support Straps to the Fly-Bar with the four supplied Bolts, Flat Washers and Lock Nuts.

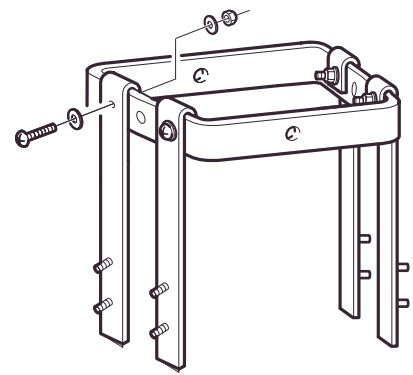

2. Orient the Fly-Bar so the wide side is to the front of the Loudspeaker. Slide the four Support Straps, loosely attached to the Fly-Bar, into the four Enclosure Channels.

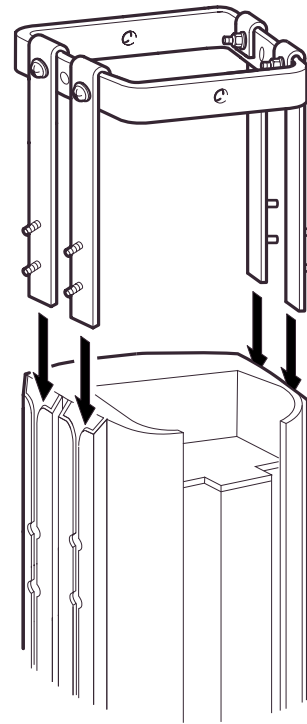

3. Align the two Threaded Studs on each Strap with the Half-Moon Cutouts in each Channel. Screw a Threaded Standoff onto each Support Strap Stud.

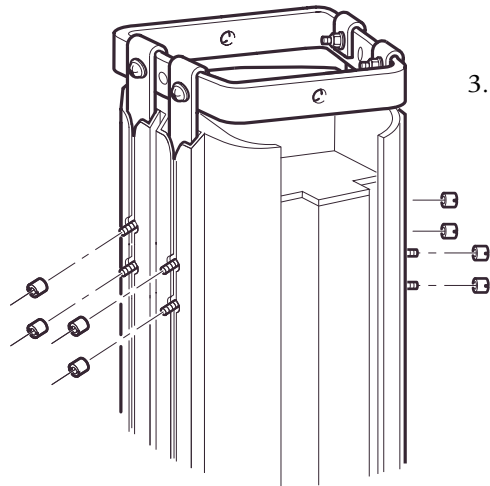

4. Ensure all Standoffs are fully inserted into the Enclosure Channel Cutouts and are seated against the Support Straps.

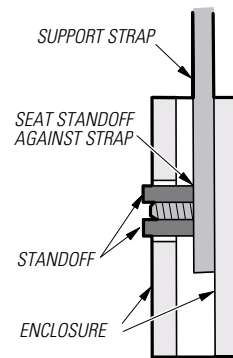

1/2" WIDE FLAT-TIP SCREWDRIVER

5. Using a 1/2" wide, flat-tip Screwdriver, firmly tighten all Standoffs. Tighten the four Fly-Bar Lock Nuts installed in Step 1 with a Phillips Screwdriver and Wrench.

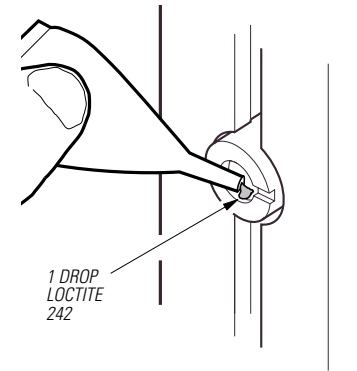
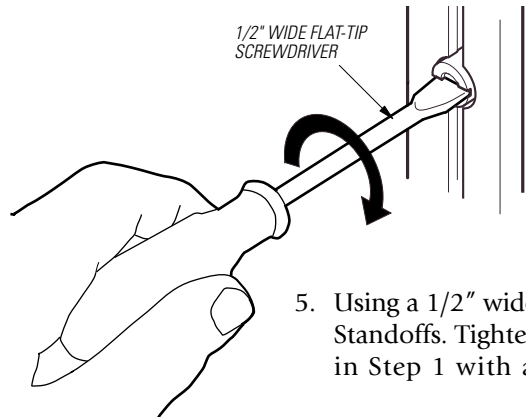

6. Apply one drop of the supplied Loctite 242 to each tightened Standoff as shown in the drawing. Once applied, allow the Loctite to cure undisturbed for a minimum of 6 hours or according to its directions.

7. Attach the supplied 3/8" Shackles to either the front and back or side holes in the Fly-Bar. Use the Shackles as the attachment points for suspension hardware that is load-rated for the weight being suspended.

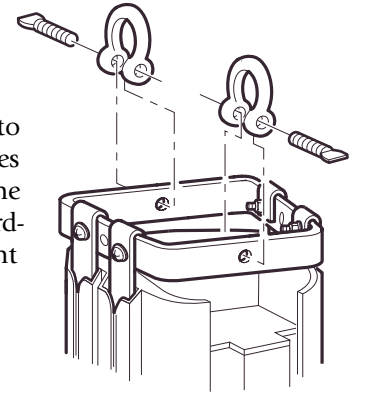

## SUSPENDING ADDITIONAL LOUDSPEAKERS BELOW (Requires an Enclosure Connecting Kit for each)

**CAUTION:** This procedure requires that the two Enclosures be vertically positioned when installing the Connecting Kit. The Connecting Straps are not designed to withstand lateral loads. If the Enclosures are connected while in other than a vertical position and then lifted to a vertical position, lateral loading of and possible damage to the Straps will occur.

1. Lift the first Enclosure high enough to allow the second Enclosure to be placed directly underneath it in a vertical position.

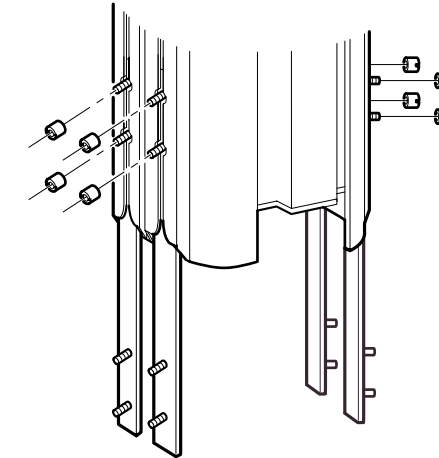
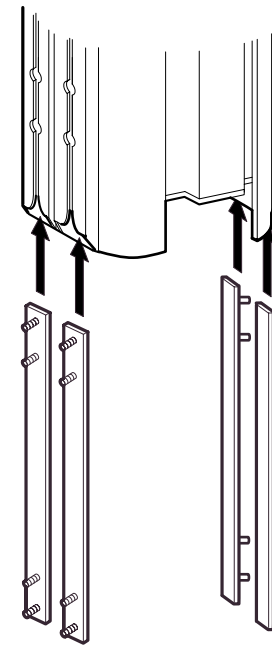

3. Fasten the 4 Connecting Straps to the upper Enclosure Channels onto each Threaded Stud. Do not tighten the Threaded Standoffs at this time.

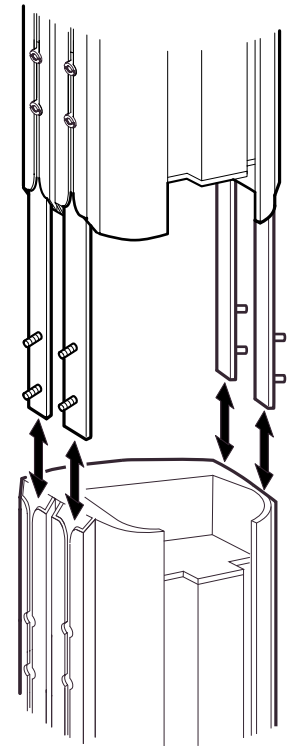

2. Slide all four Connecting Straps up into the upper Enclosure Channels. Align the Threaded Studs to the Half-Moon Channel Cutouts.

4. Bring the Enclosures together so the Connecting Straps slide into the bottom Enclosure's Channels. Align the Threaded Studs with the Half-Moon Channel Cutouts in the lower Enclosure.